

# MEDEA 2/D

## VITRINA

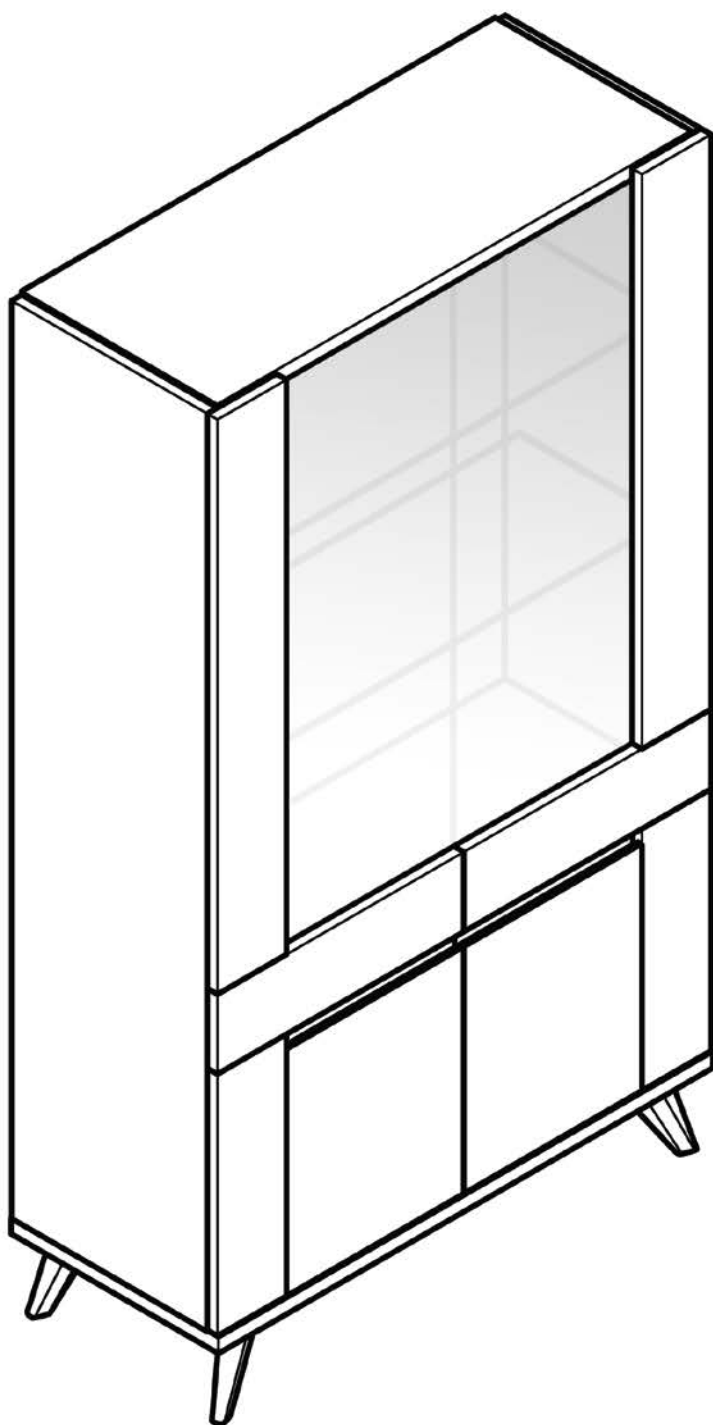

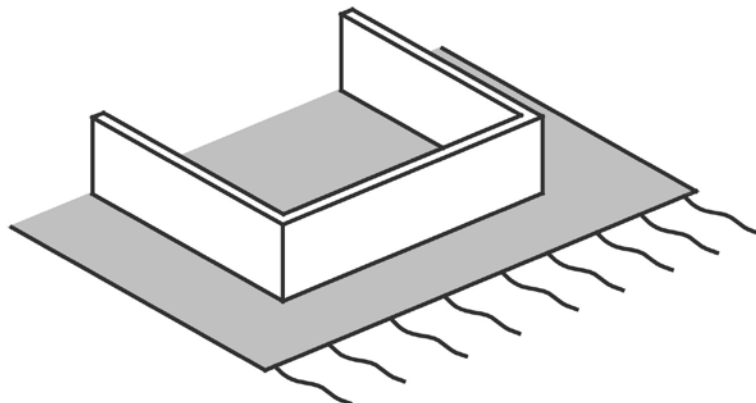

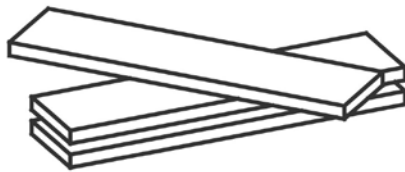
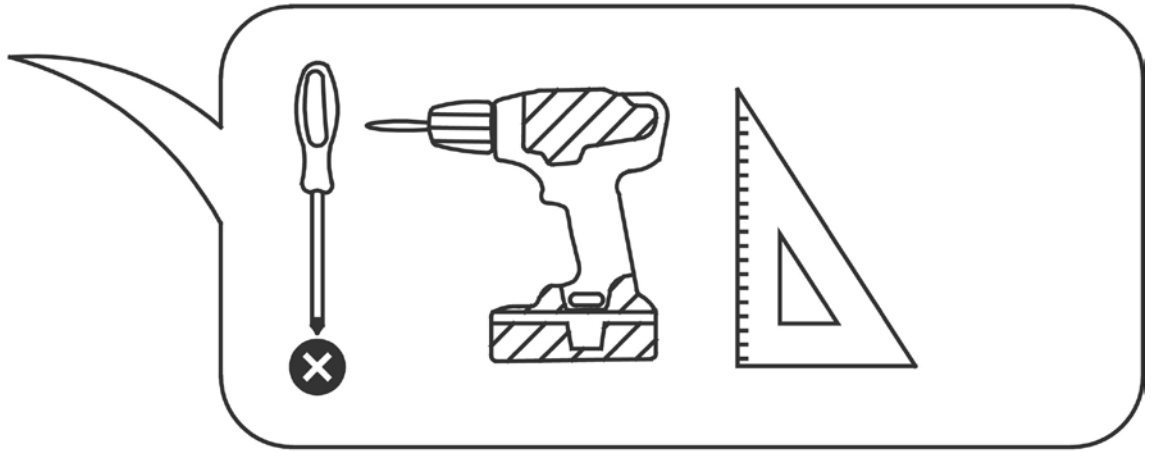

1SPIN000

x18



1ECC000

x12



1PERN000

x12

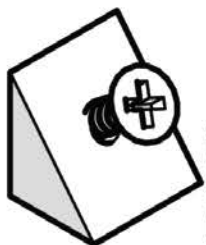

1FERM000

x28

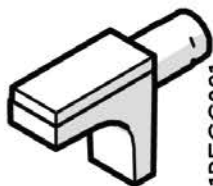

1REGG021

x8

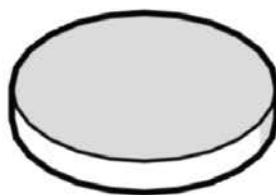

1FELT000

x4



1CFOR000

x12

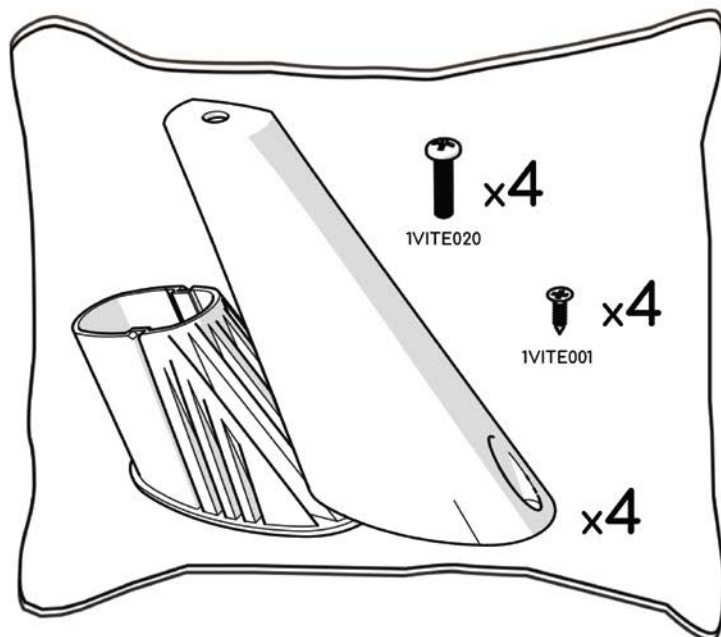
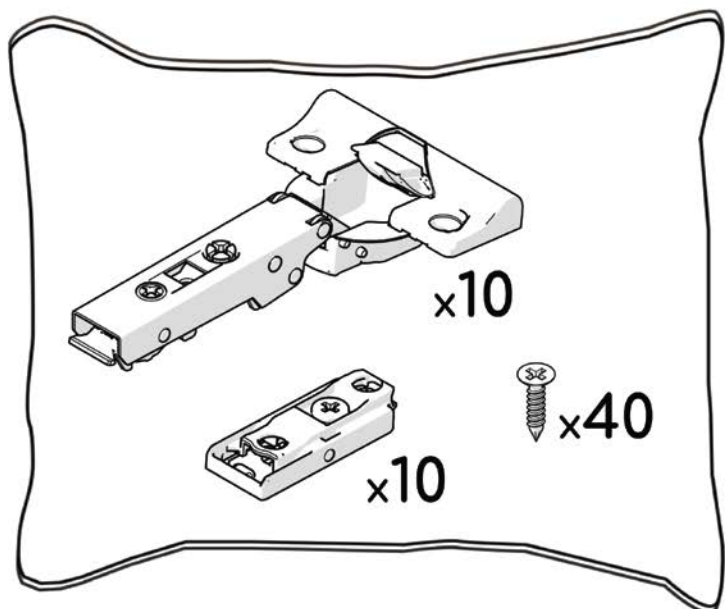

1.

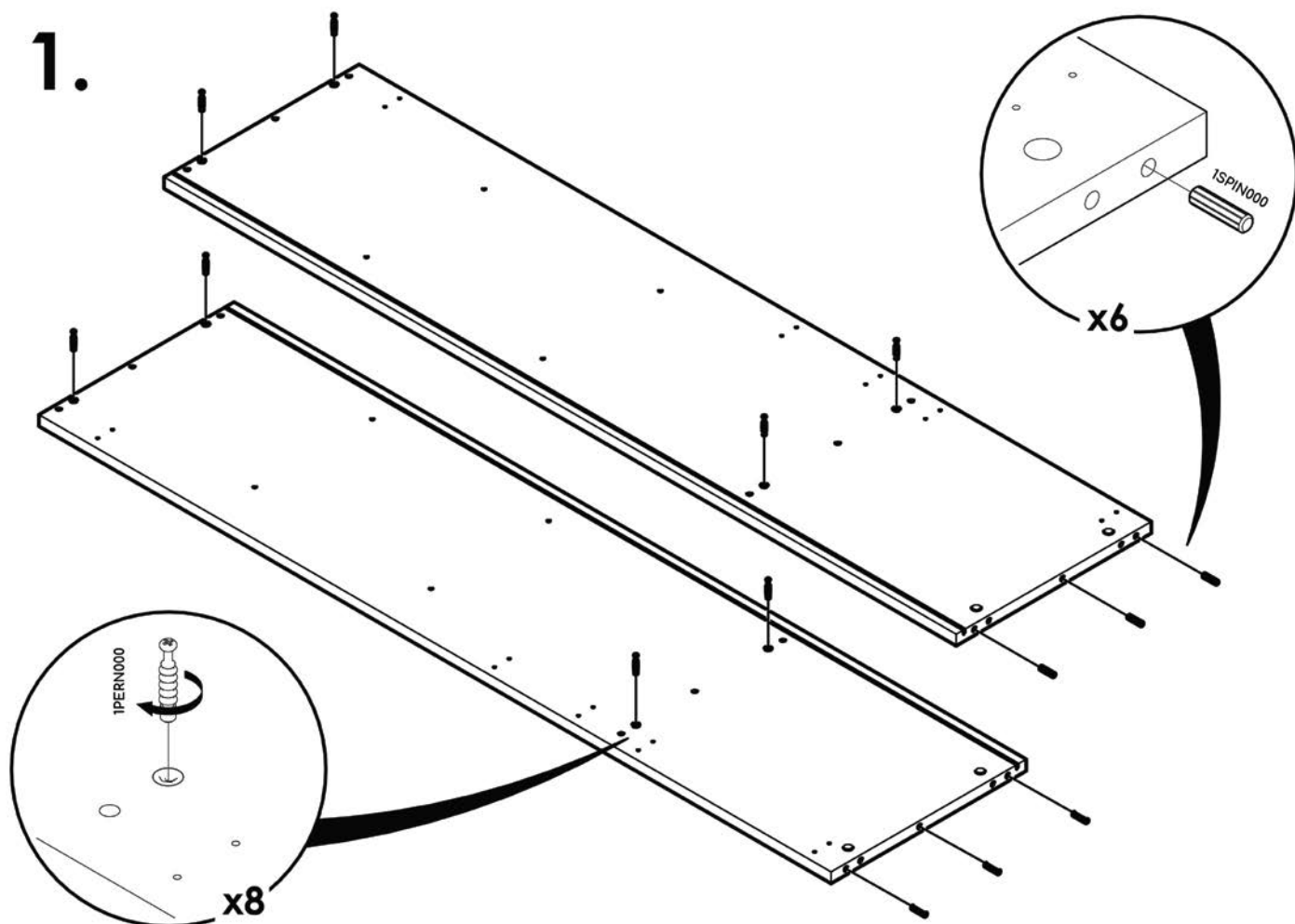

2.

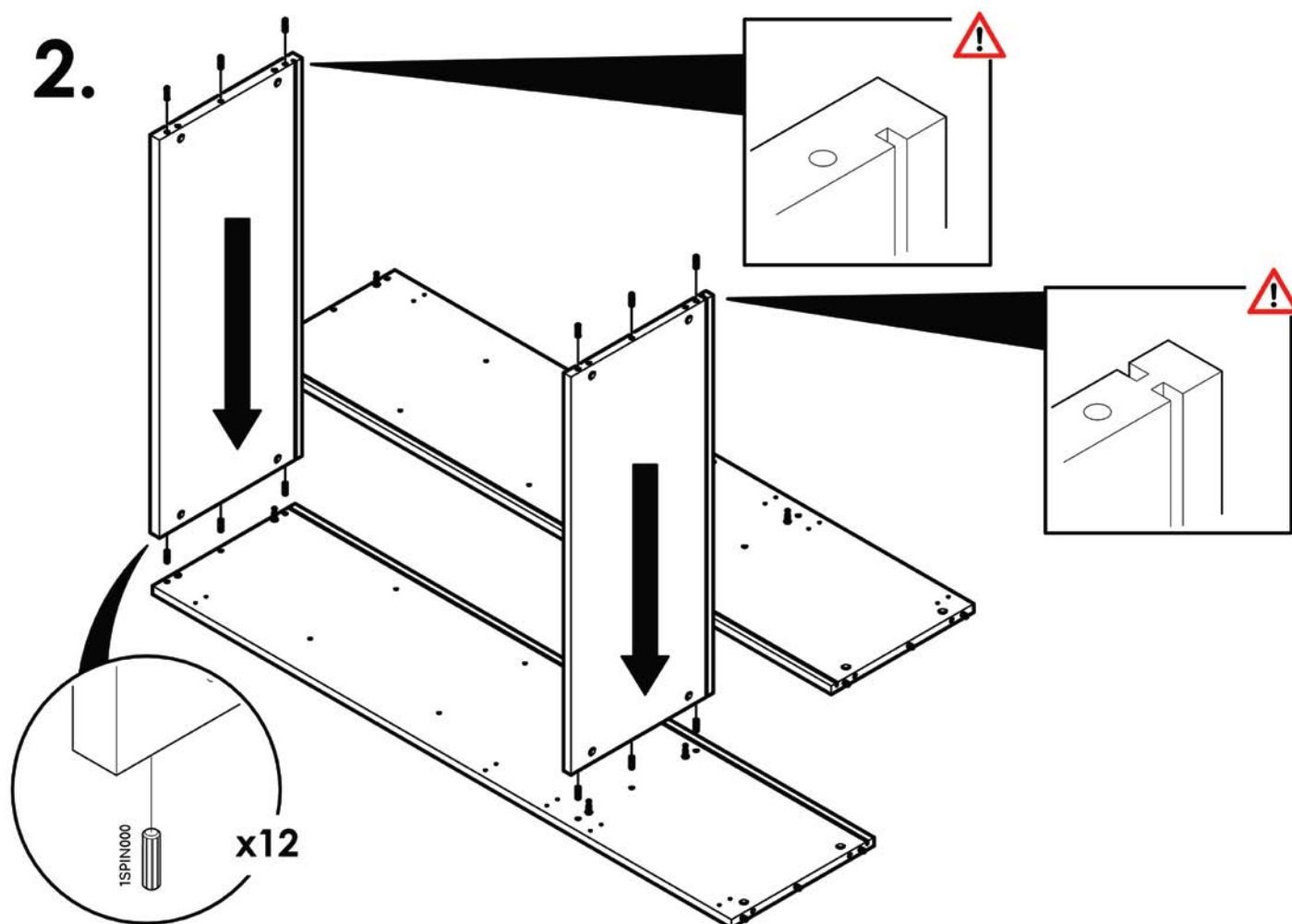

**3.**

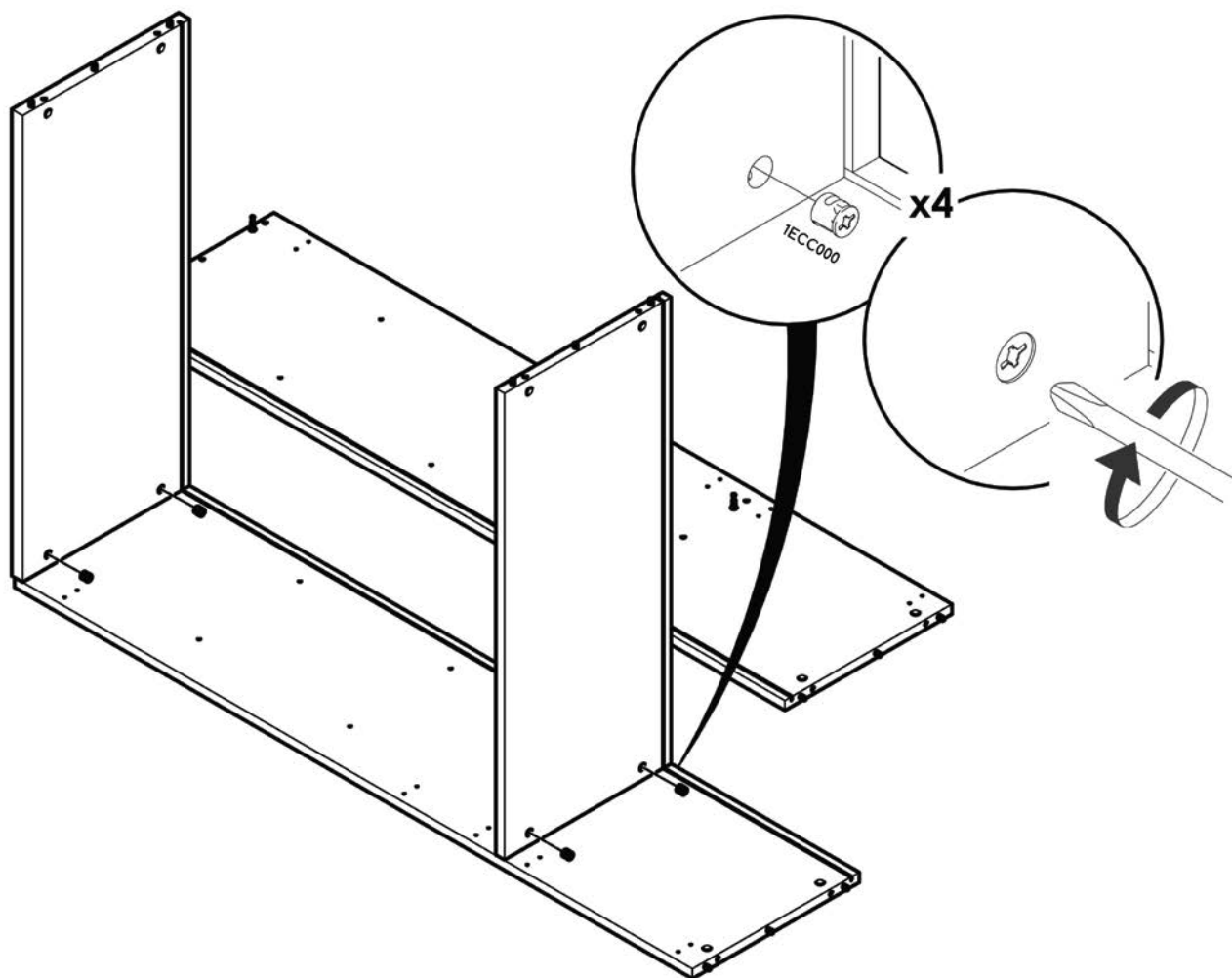

**4.**

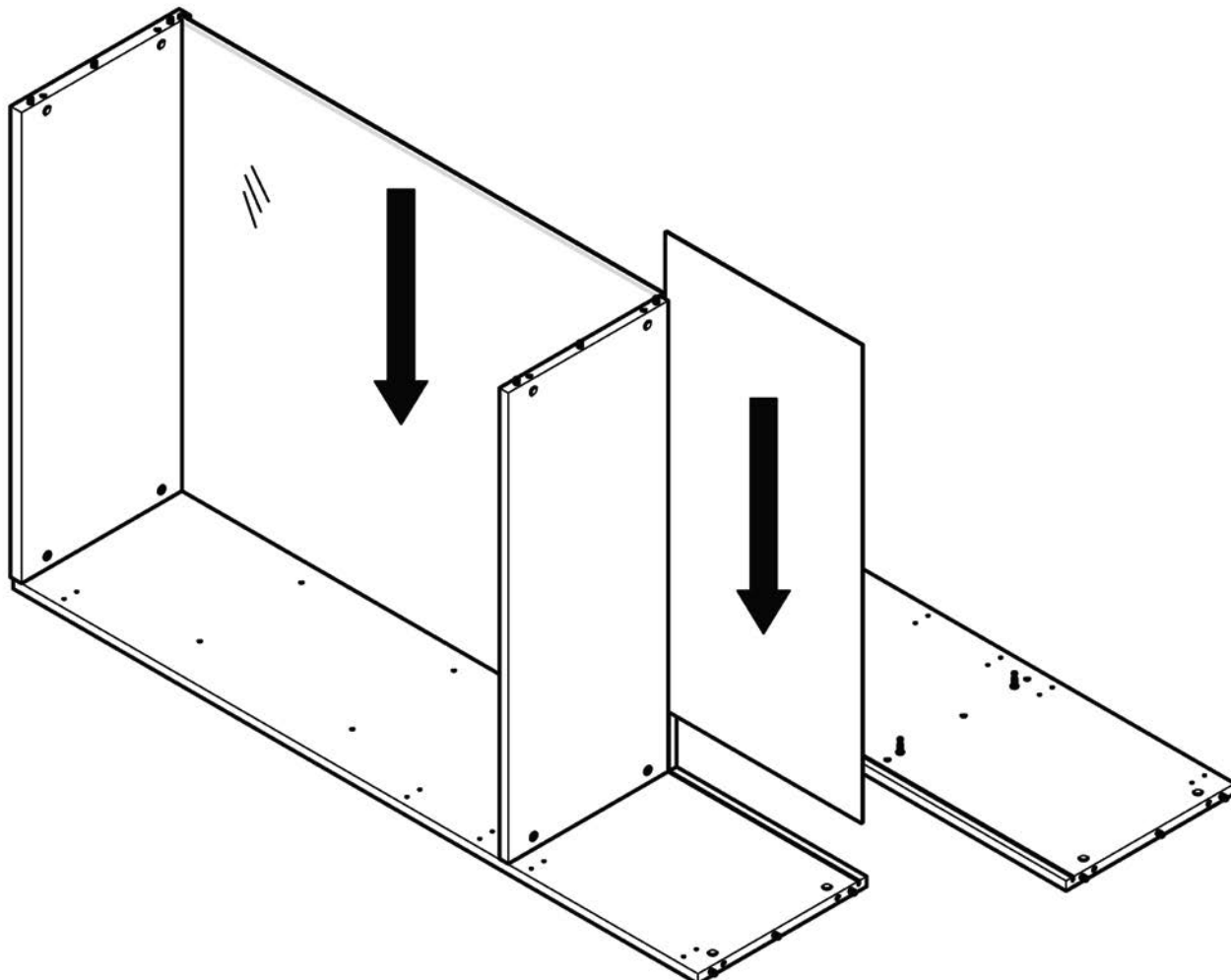

5.

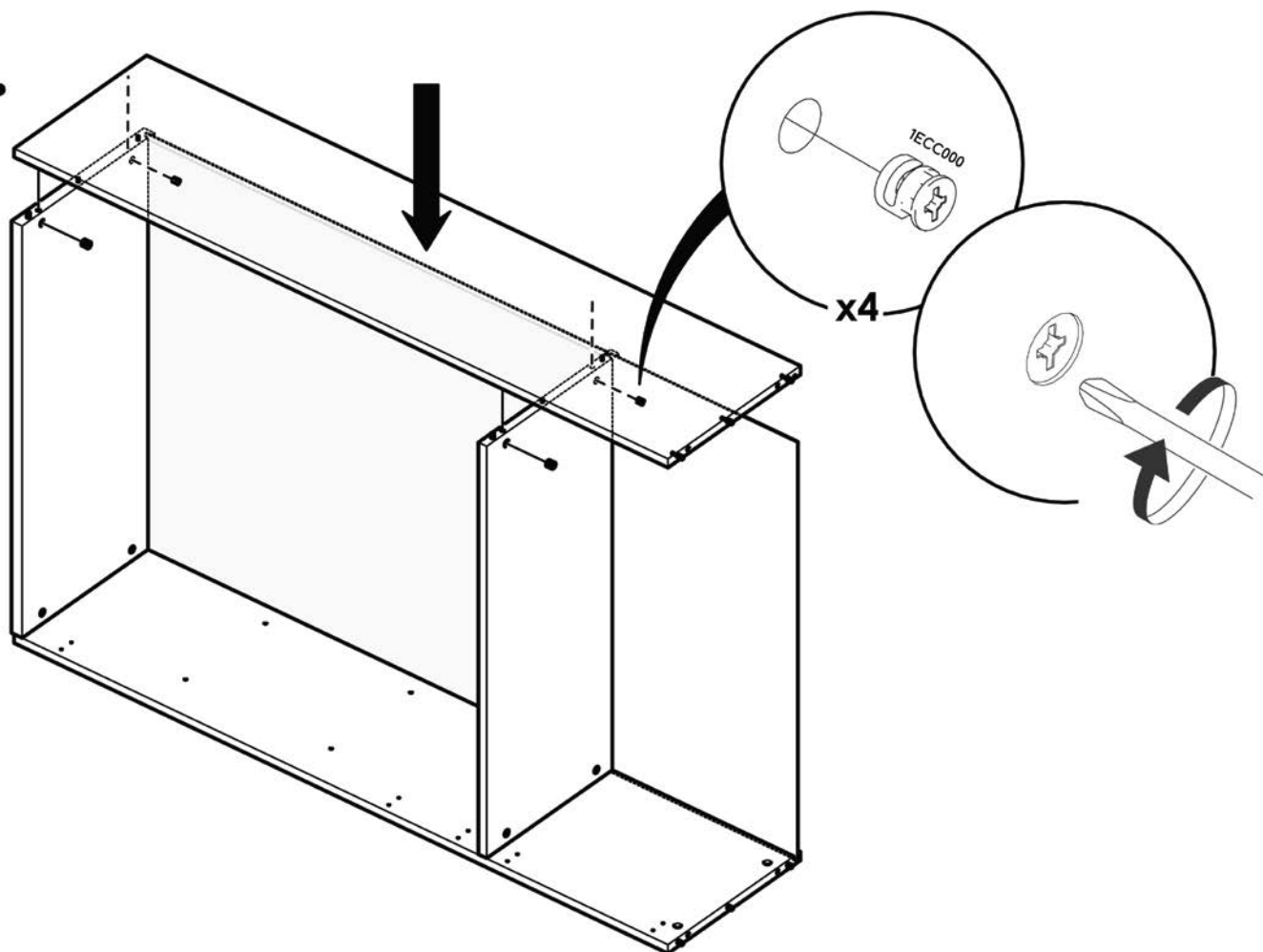

6.

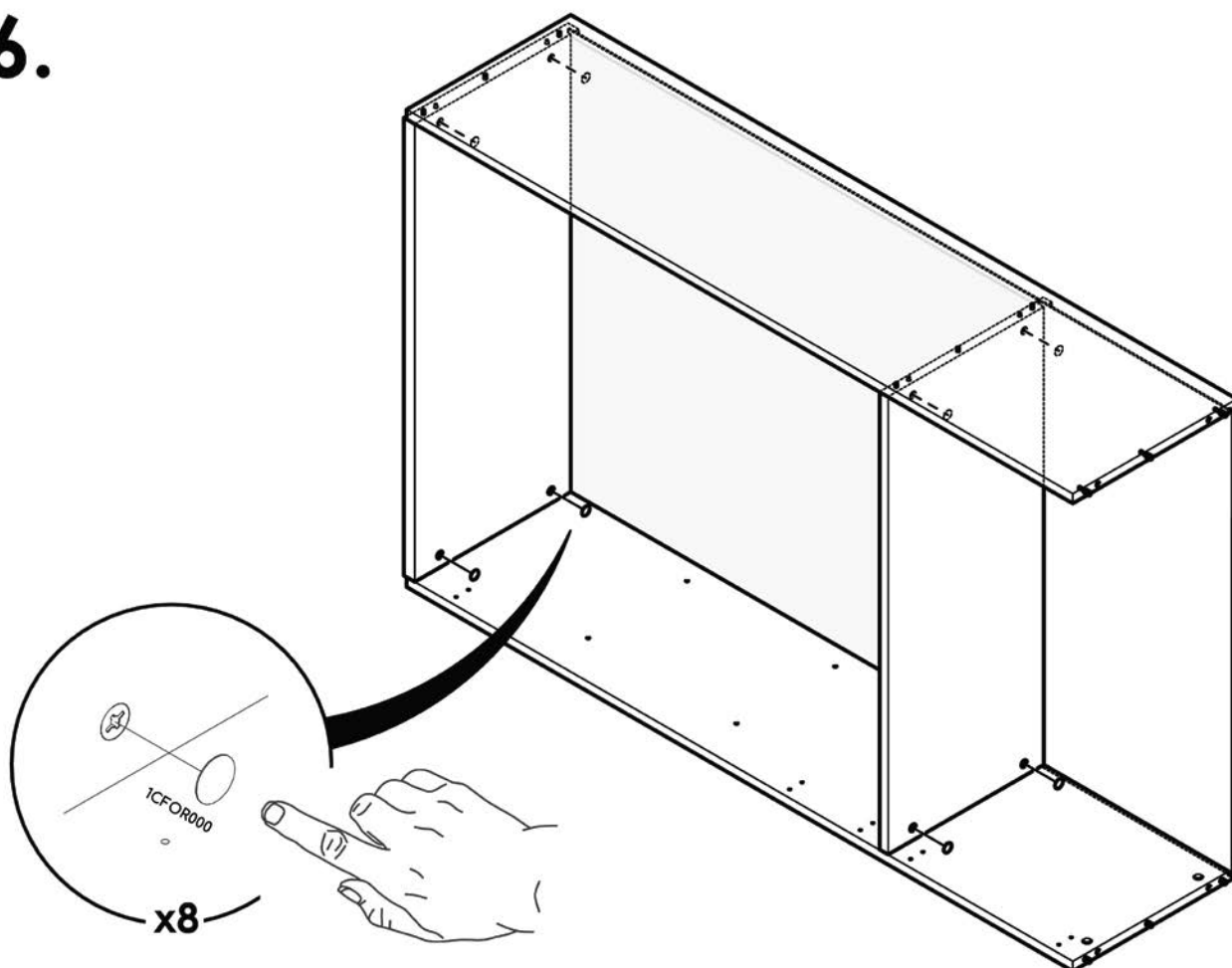

8.

Diagram 8 illustrates the process of attaching the bottom panel to the side panel. The bottom panel, which has four legs, is shown being moved into position. A circular inset provides a detailed view of the fastener used: a screw labeled '1PERN000' is shown being inserted into a pre-drilled hole in the bottom panel. The quantity 'x4' indicates that four of these screws are required for this step.



9.

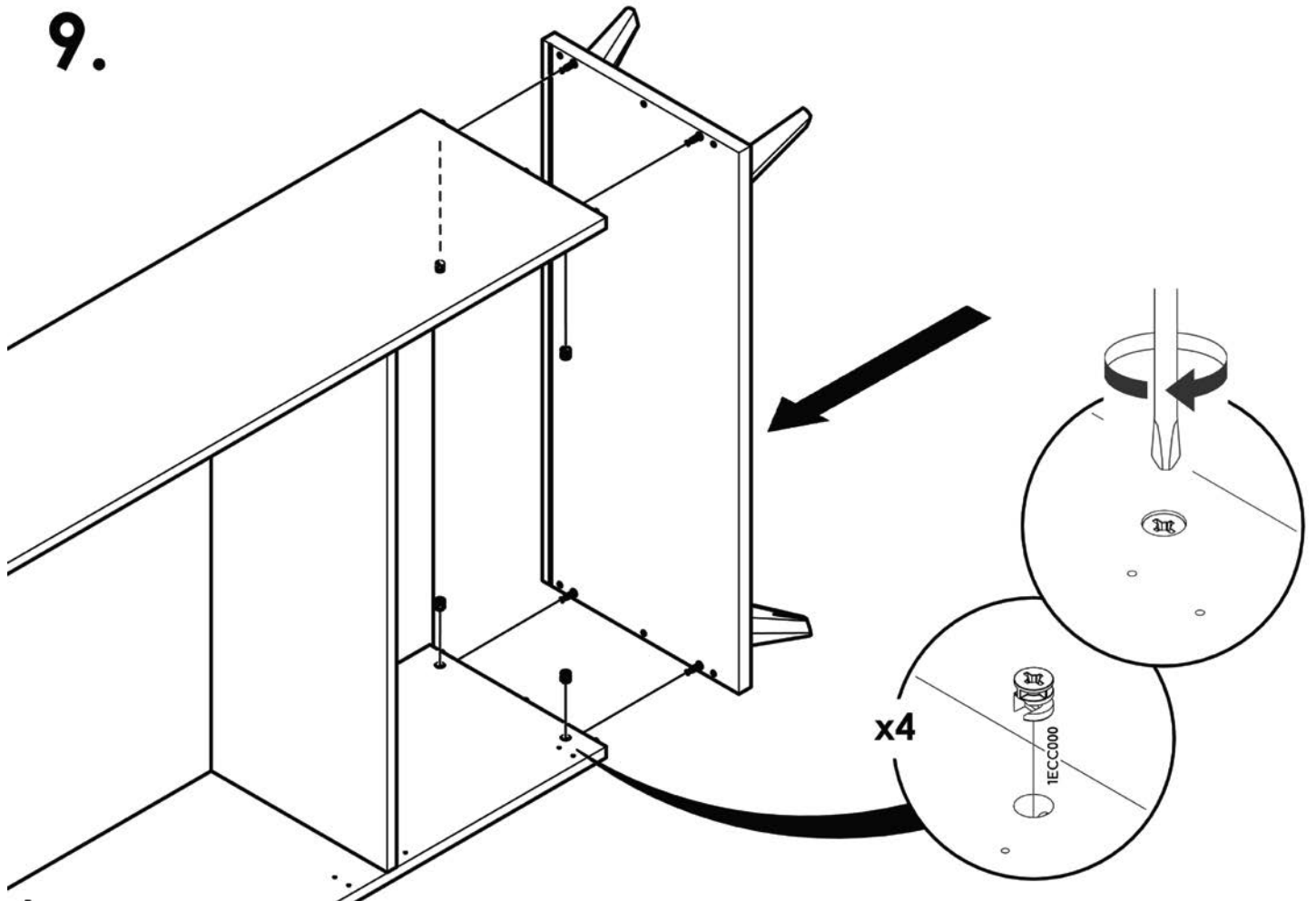

10.

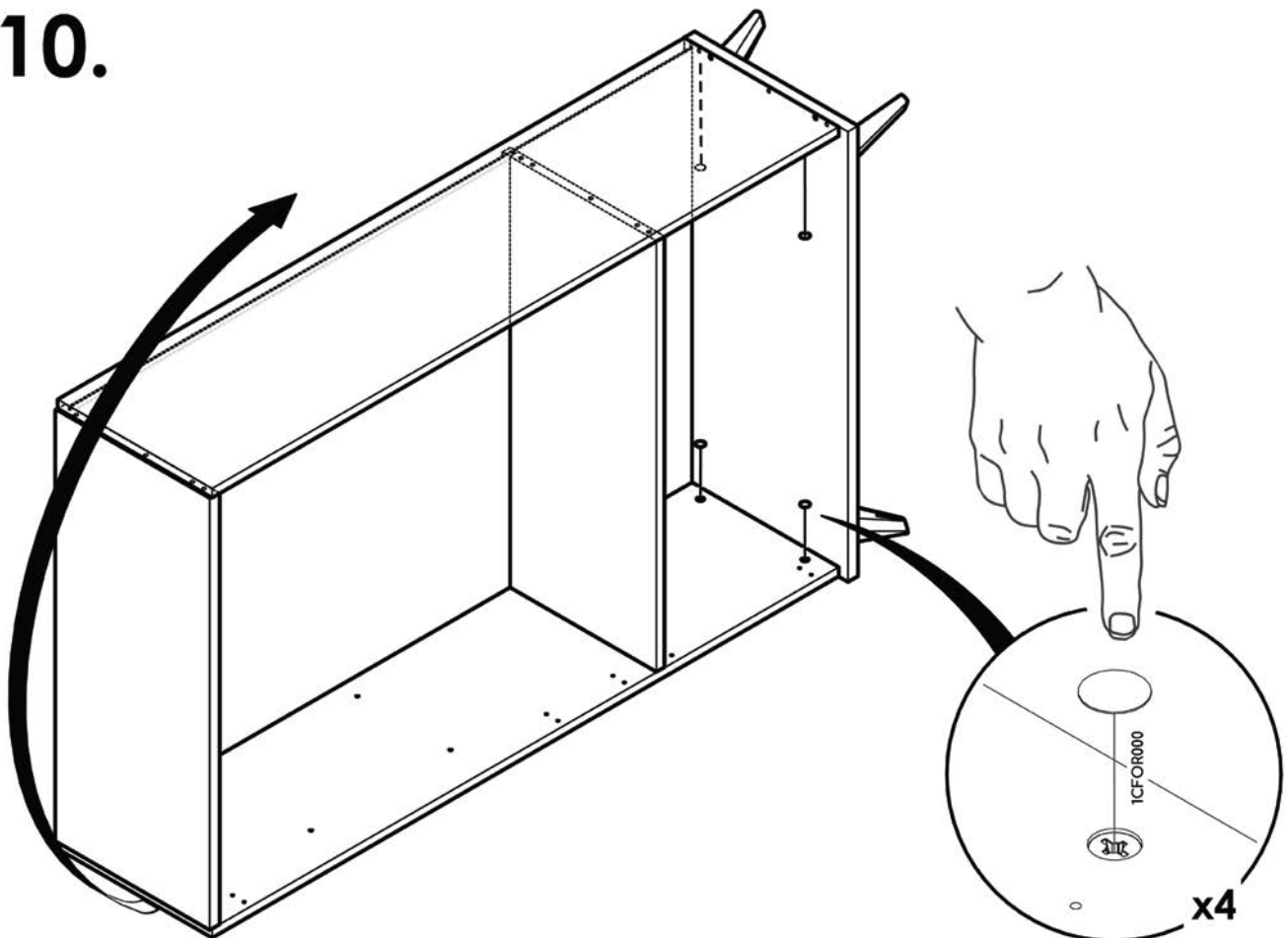

# 11.

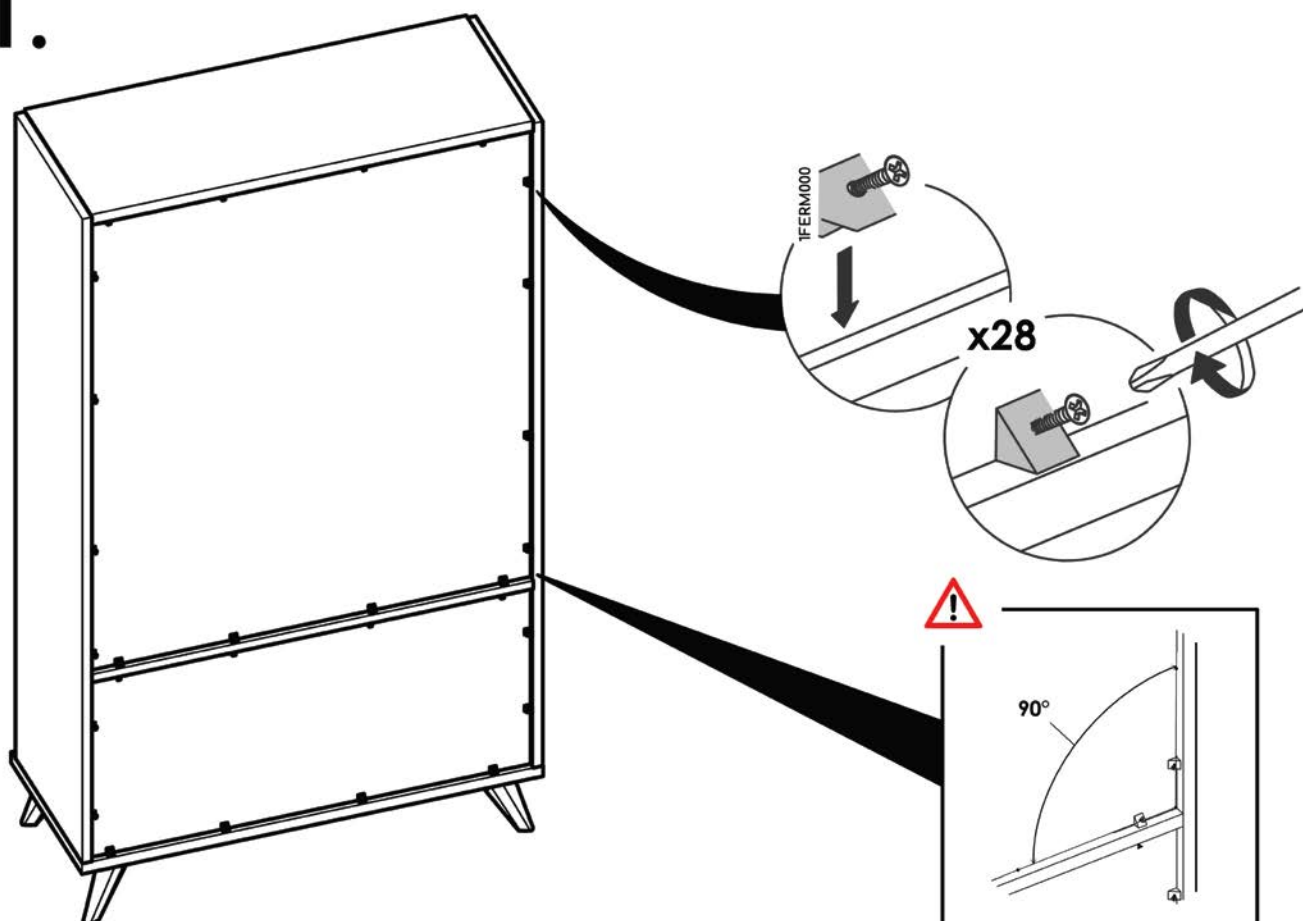

# 12.

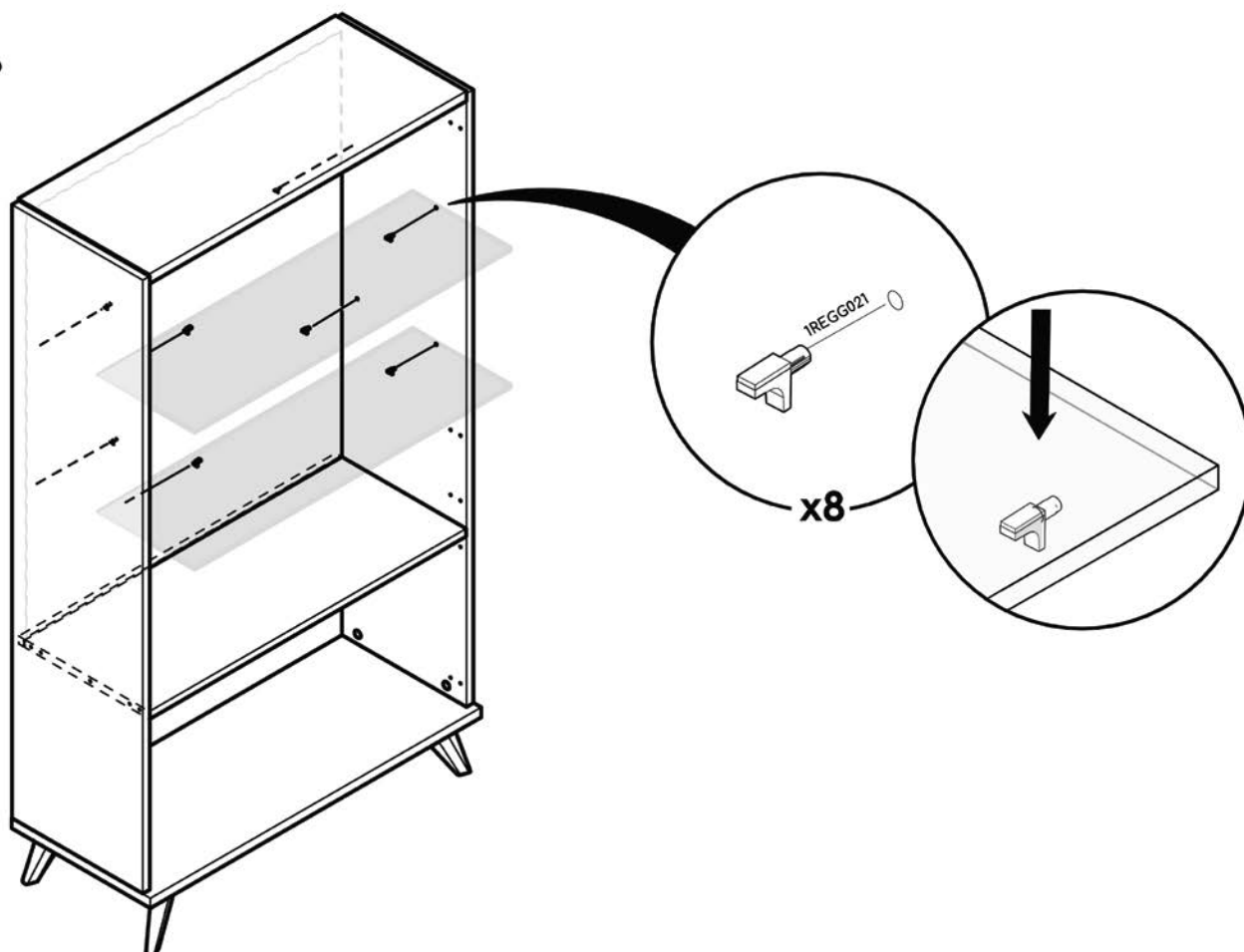

13.

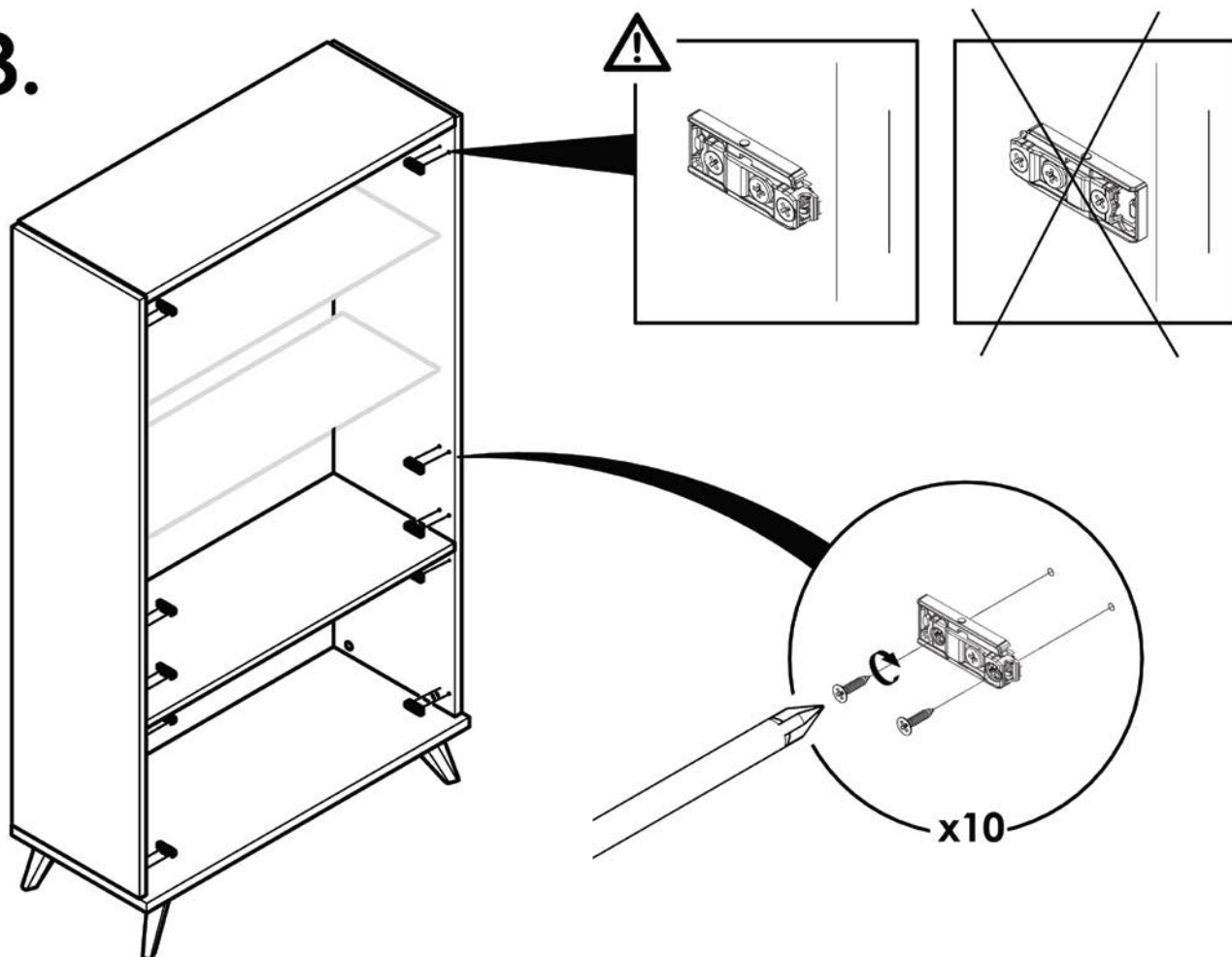

14.

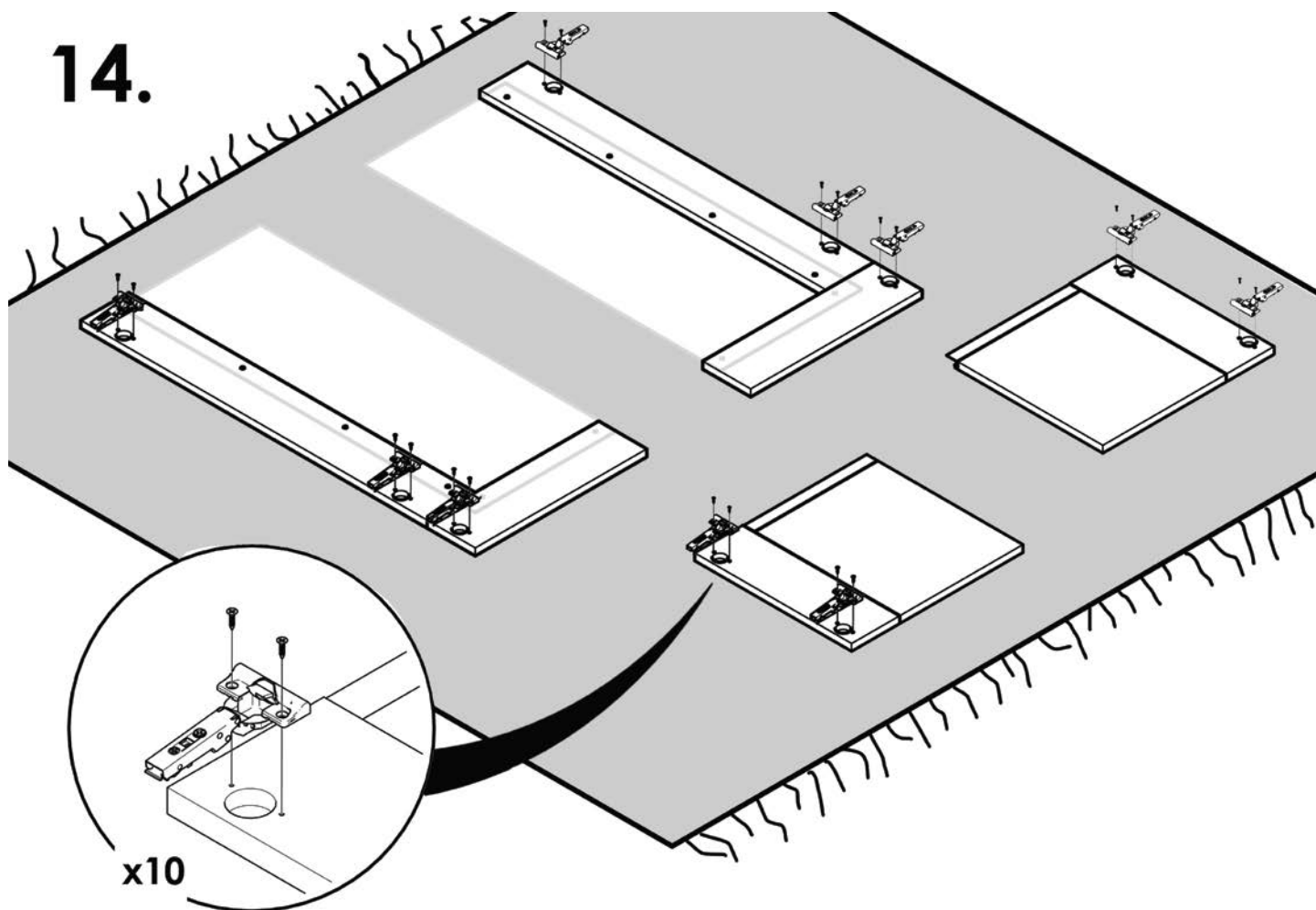

15.

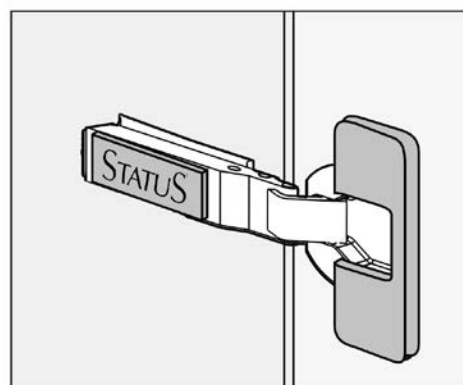
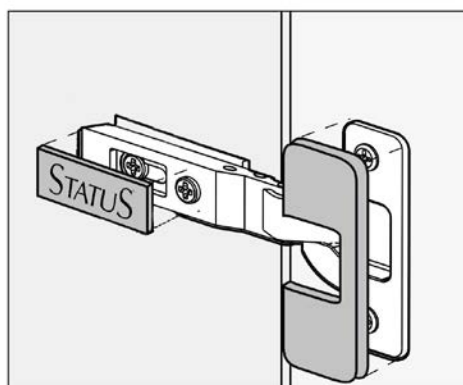
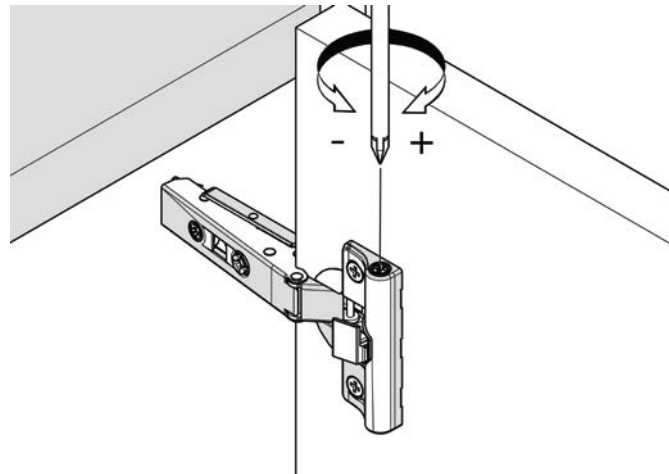
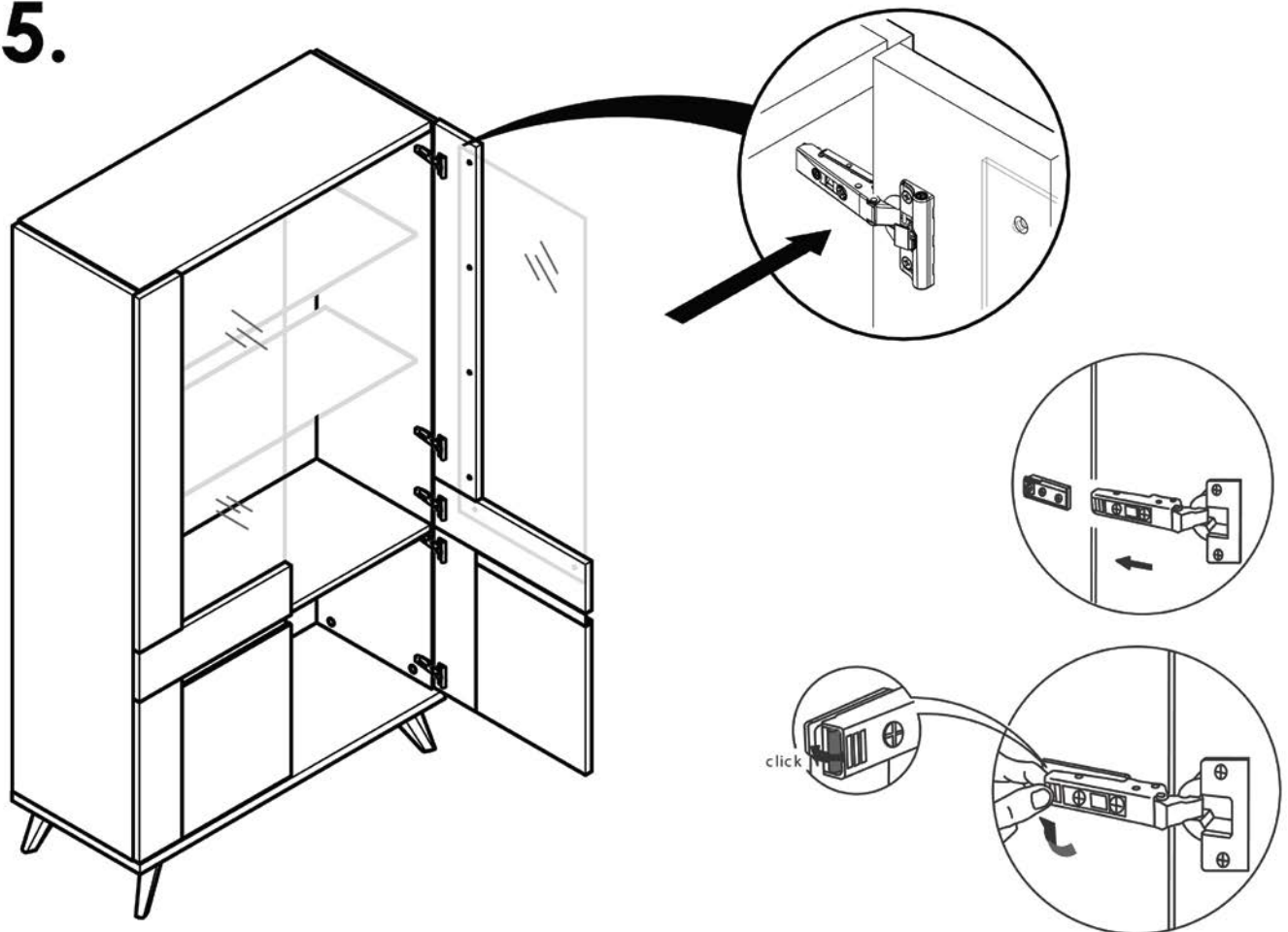

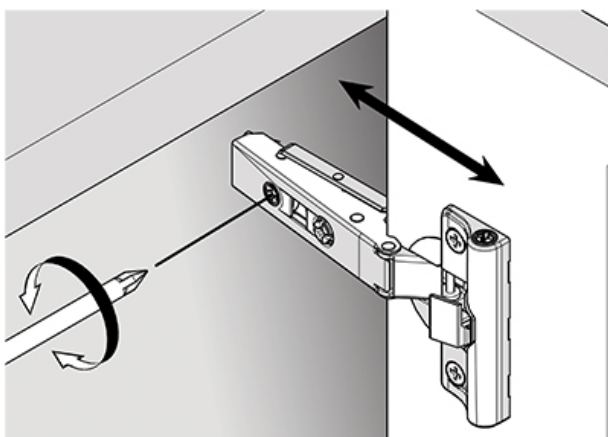
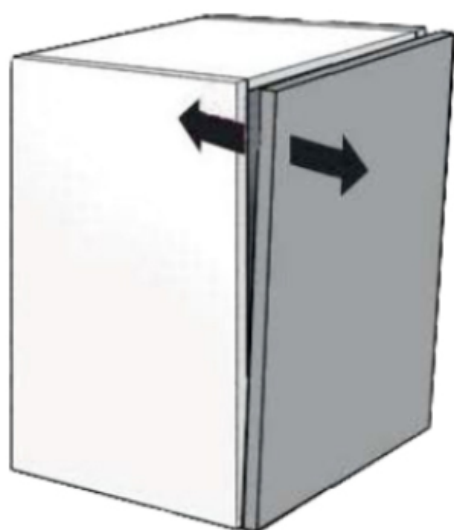
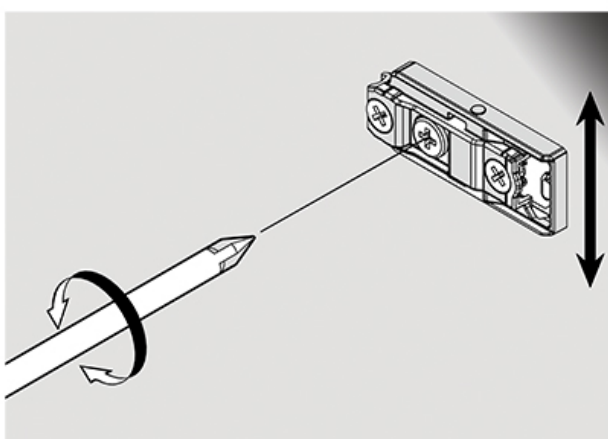
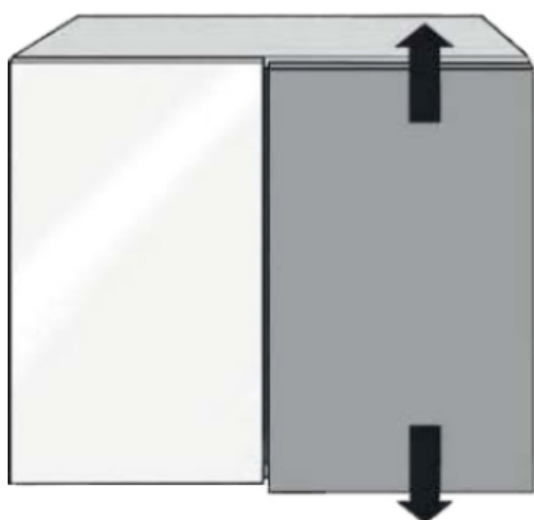
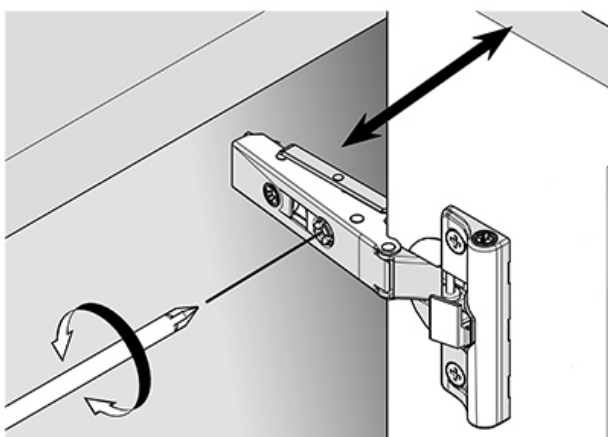
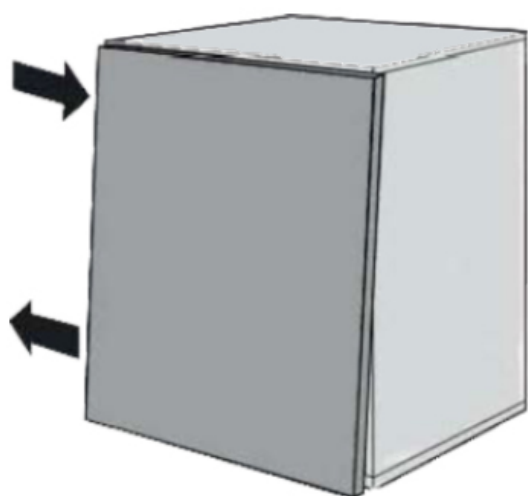

# STATUS<sup>®</sup>

Italian status symbol

SUKURTA IR PAGAMINTA ITALIJOJE

AČIŪ, KAD RENKTĖS MŪSŲ PRODUKCIJĄ



VIA DELLE INDUSTRIE 6/A - 31018 GAIARINE (TV) – ITALY



[info@statusitaly.it](mailto:info@statusitaly.it)



+ 39 0434 75195